

9 SPECIFICATIONS

MODEL	200CFA	300CFA	400CFA	600CFA
Max. Seal Length	200mm	300mm	400mm	600mm
Seal Width	10/15mm	10/15mm	10/15mm	10/15mm
Temper. Range	30-199C	30-199C	30-199C	30-199C
Sealing Time	0.2-2.5sec	0.2-2.5sec	0.2-2.5sec	0.2-2.5sec
Re-Cycle Time	1.0-8.0sec	1.0-8.0sec	1.0-8.0sec	1.0-8.0sec
Watts	350W	450W	520W	600W
Weight	15kg	17kg	19kg	22kg



**BOATMAN
MARKING**

Packaging Supplies & Equipment

BOATMAN MARKING
2553 Lee Avenue
South El Monte, CA 91733
Phone: (626) 350-9700
Fax: (626) 350-8045

CONSTANT AUTOMATIC SEALER

200CFA, 300CFA, 400CFA, 600CFA

(CFV SERIES)

INSTRUCTION

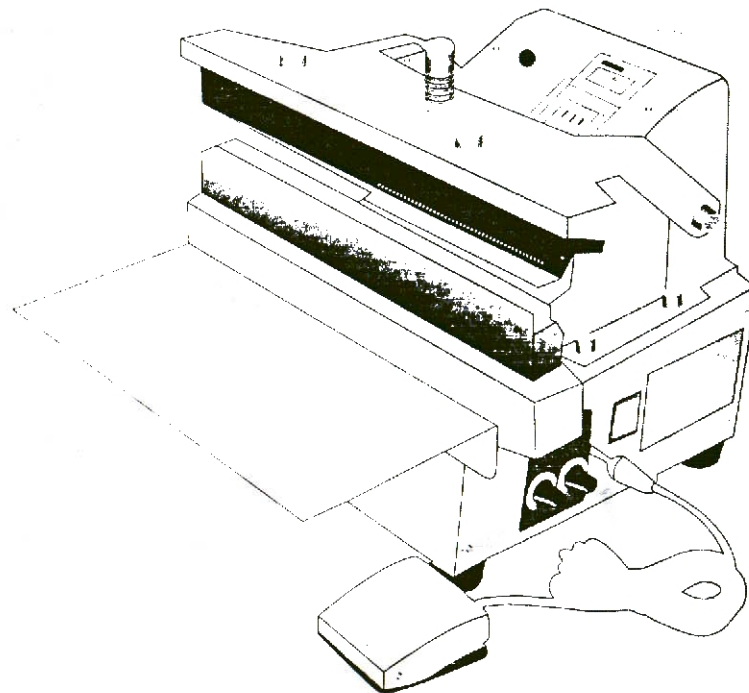

1 CONSTRUCTION DIAGRAM

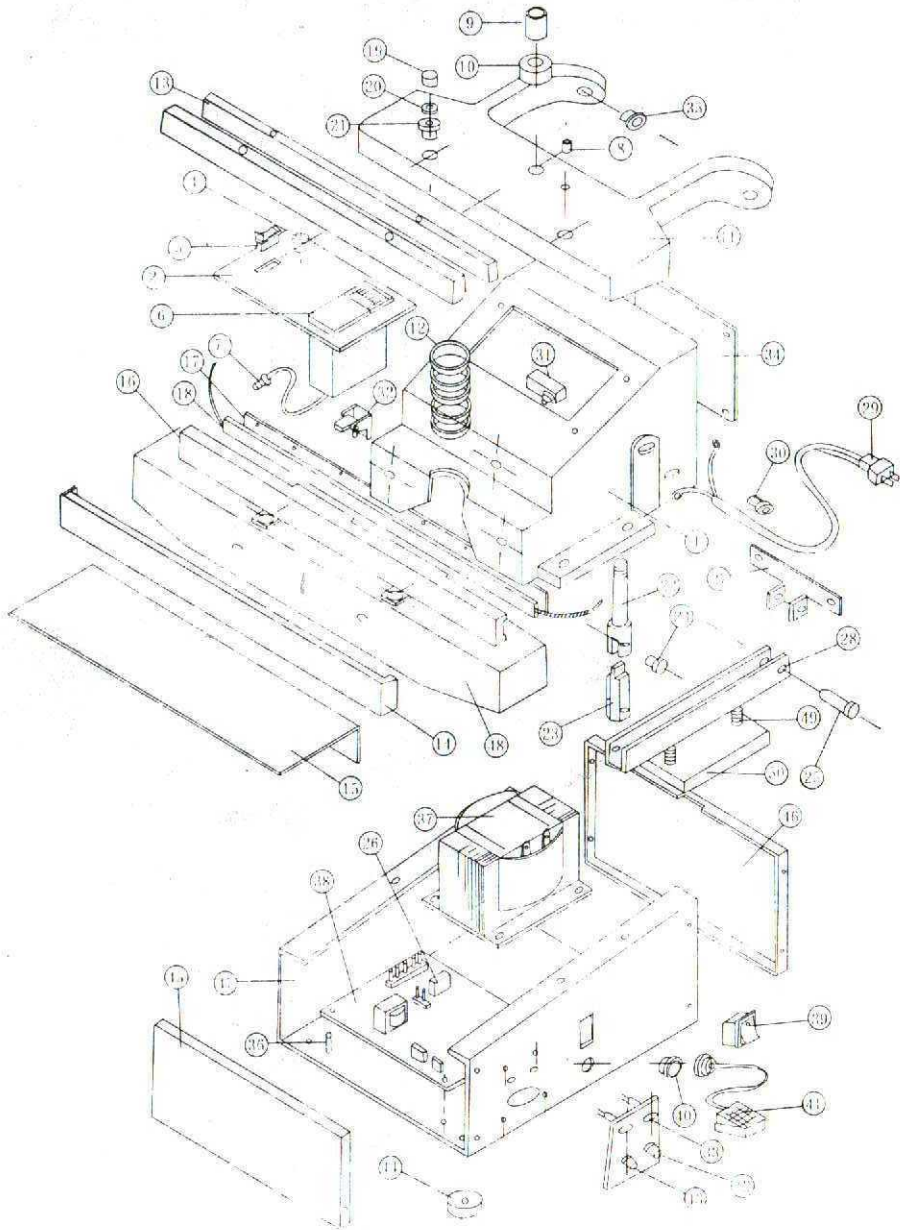

2 PARTS LIST

- | | |
|------------------------|-----------------------------|
| 1. ENCLOSURE | 26. RELAY |
| 2. CONTRAL PLATE | 27. HINGE BRACKET |
| 3. FUSE 10A | 28. UPPER JAW LEVER |
| 4. FUSEHOLDER | 29. POWER SUPPLY CORD |
| 5. POWER SWITCH | 30. STRAIN RELIEF BUSHING |
| 6. TEMPER. CONTROL | 31. LIMITED SWITCH |
| 7. TEMPERATURE COUPLE | 32. INTERLOCK SWITCH |
| 8. SETTING BOLT NUT | 33. PILOT LAMP |
| 9. UPPER LEVER NUT | 34. ENCLOSURE COVER |
| 10. PRESSING RUBBER | 35. FLANGE BEARING |
| 11. UPPER JAW | 36. SPACER SUPPORT |
| 12. UPPER JAW SPRING | 37. SOLENOID |
| 13. UPPER HEATER JAW | 38. CONTROL-PCB |
| 14. PROTECTION PLATE | 39. ACTION SELECTOR |
| 15. WORKING PLATE | 40. CONNECTOR FOOT SWITCH |
| 16. DOWER HEATER JAW | 41. FOOT PEDAL |
| 17. HEATER COVER | 42. RE-CYCLE TIMER |
| 18. HEATER BAND | 43. SEALING TIMER |
| 19. SCREW CAP | 44. RUBBER FOOT |
| 20. WASHER FOR JAW | 45. FORNT PLATE |
| 21. SILICON RUBBER PAD | 46. BACK PLATE |
| 22. UPPER LEVER | 47. ENCLOSURE BASE |
| 23. DOWER LEVER | 48. LOWER JAW |
| 24. GROOVE SCREW | 49. SPRING FOR MAGNET PLATE |
| 25. GROOVE PIN | 50. MAGNET PLATE |

3 CONNECTION DIAGRAM

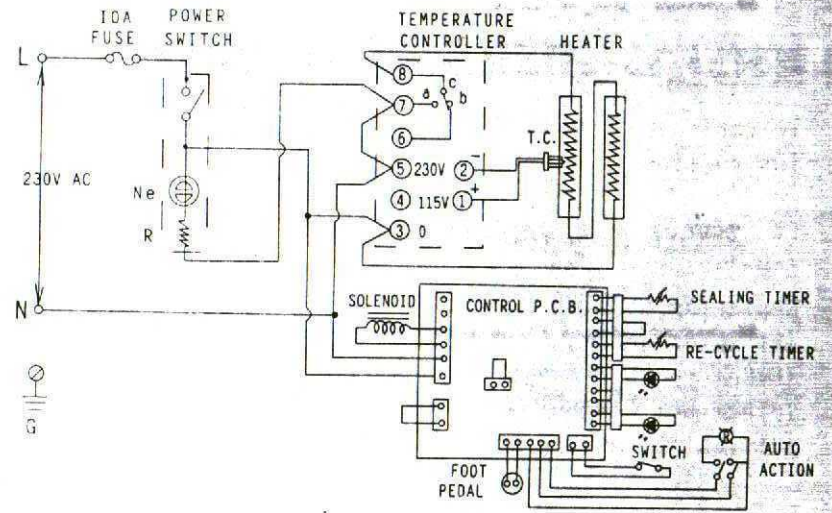

4 HELPFUL INFORMATION

1. Always keep the sealer jaws platform clean. Particular care should be taken to remove any residue from both sides of the heater jaws.
2. Do not clean the sealer jaws platform with anything wet.
3. Occasionally check the condition both side of the heater jaws. A poor sealer platform will effect on the quality of your seal.
4. Use only genuine replacement parts.

THIS MACHINE HAS AN ADDED SAFETY FEATURE FOR YOUR PROTECTION. THE SEALER JAW WILL FAIL TO CLOSE COMPLETELY IF A FOREIGN OBJECT AS A FINGER OR TOOL IS BETWEEN THE JAWS.

TO REACTIVATE THE SEALER, TURN OFF THE POWER SWITCH, WAIT 3 SECONDS AND PUT SWITCH BACK ON, MACHINE WILL AGAIN BE OPERATIONAL.

5 CHANGING PARTS

To replace burnt out heating band please follow these instructions:

REMOVE PLUG FROM ELECTRIC OUTLET.

Replacing heating band.

- (a) Loosen screws from both side of body.
- (b) Remove heater band from heating jaw.
- (c) Put new element band on heater jaw.
- (d) Tighten heating band in the heater jaw.
Connect wire and heating band with screws.

HEATING JAW HOLD SCREW

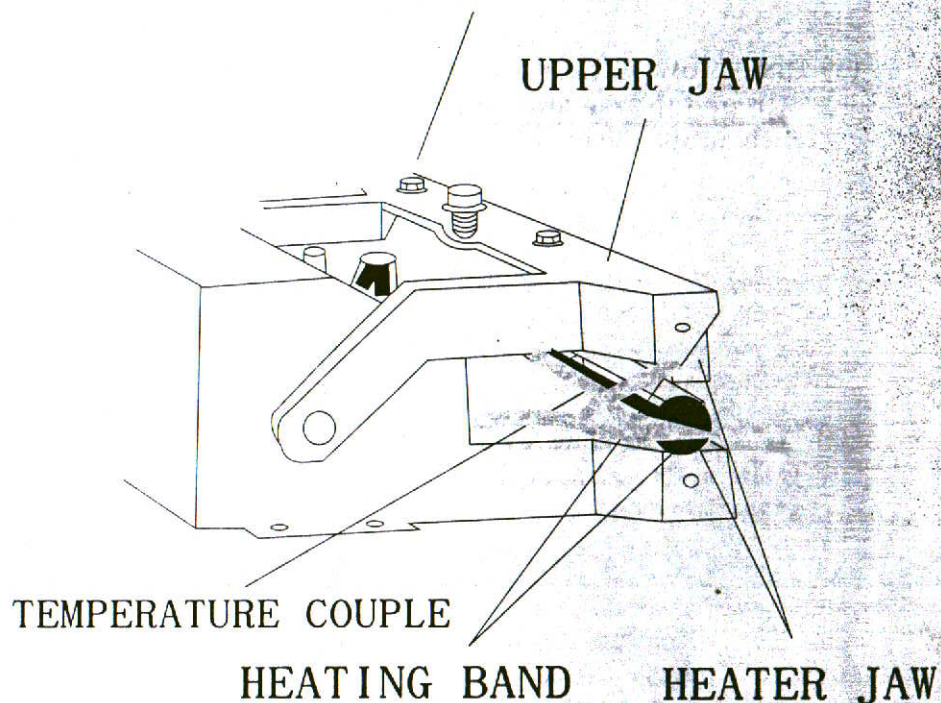

6 CAUTIONARY MARKINGS

- CAUTION** -To reduce the risk of shock, disconnect the unit from the supply circuit before servicing the replacement of the heating element.
- To provide continued protection against risk of electric shock, connect to properly grounded outlet only.
- WARNING** -For Continued Protection Against Fire or Electric shock
Replace Only With Type Cartridge and 10A Ampere Fuse.
Provided in legible adjacent to fuseholder.

7 ASSEMBLING FOR VERTICAL FDV SEALER

(1). Insert lower standing tube into pedal base and connect with short screws.

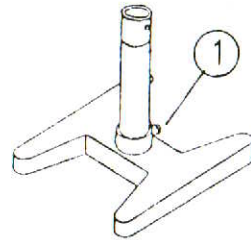

(2). With four long screws connect with body to the upper standing tube.

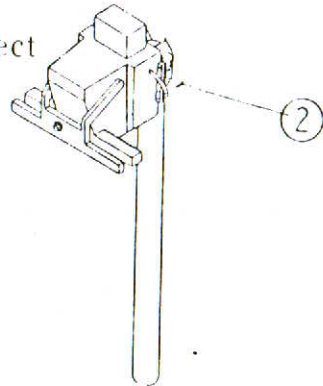

(3). Insert body upper standing tube into lower standing tube base then fitting screw.

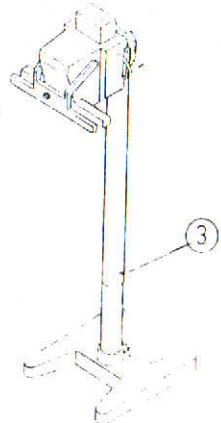

5

4. Fitting working plate to standing tube with four screws.

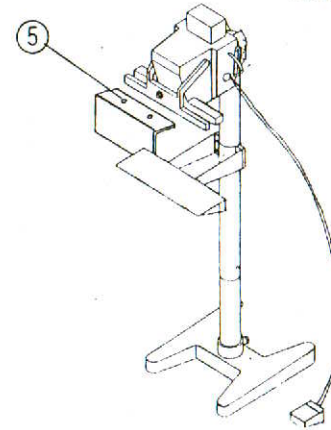
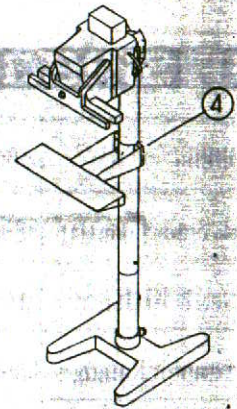

5. With two screws fitting back plate to under body then connect the foot switch.

8 OPERATING INSTRUCTIONS

1. Turn on Master Switch, Yellow light appears.
2. Set Action selector to MAN for manual operation by pressing the foot Pedal switch, or set to AUTO for automatic cyclical operation.
3. Adjust the Sealing Knob to set sealing time.
4. Adjust the Re-Cycle Knob to set the frequency of continuous works it is the waiting time.
5. Set the temperature digital knob to 100°C the green LED light will change automatically into red light about five minute, it is the heating time.
6. To operate unit, Step on Foot Pedal, sealer jaw will close and then be sealing. The Jaws will open automatically when cycle is completed.
7. If it does not complete with the seal, set the temperature digital knob add and go through process in 5 until you get desired seal.

6